

# Amazon Cruise Planner and Tariff 2021-2023

Expedition Cruises on  
*The Motor Yacht Tucano*



*Well beyond the ordinary*

*Far into the Wild*

*Way off the grid*

*Active*

*Unique*

*Adventurous*

*Nimble*

*Smart*

*Stylish*

*Elegant*

**SAFE**



# Amazon Cruise Tariff and Sales Guide - 2021-2023

## *What Makes the Best Amazon Cruise? Active, Authentic, and Meaningful* *The Motor Yacht Tucano*

Dear Colleague in Travel:

What do travelers want having gone through this pandemic? Of course, they want to feel safe. But more than this, having come through this difficult time, many travelers really want to have *meaningful experiences*. We feel the same way. Let us share our passion for nature with your travelers and offer them an unforgettable experience in this greatest wilderness on Earth.

### *Your Travelers Will Feel Safe*

#### **Our cruises are naturally safe.....**

**1) Small Groups:** With a small number of travelers and crew we can be sure that our contacts are healthy.

**2) Wilderness Sanctuary:** We are in very remote wild rainforest, away from groups of people and other travelers! We distance by hundreds of miles!

**3) Our Staff:** It's the people that count. Our crew members have worked with us for decades. They are conscientious, thoughtful, and very careful. We all take care of each other!

#### **And Now in Some New Ways.....**

**4) Safe Zone:** We have a host of procedures and policies to keep people safe. Everyone and everything that enters our Tucano Safe Zone has been cleared to be healthy and contamination free, and we keep it that way. A summary is at the end of this tariff.

**5) Tucano Rendezvous:** An important part of our safe zone is the new departure / arrival lounge in the historic city center of Manaus, the *Tucano Rendezvous*. Here travelers check in before the cruise and at the end of the cruise they can relax before outbound flights - staying in the zone!

**6) Vaccination Required:** Everyone that comes into our safe zone, crew and passengers alike, must be vaccinated.



Index	
Why Love our Cruises? -----	p 3
Tariffs for Two Amazon Cruises-----	p 4-5
6N Cruise: Voyage to the Heart of the Amazon	p 6-7
4N Cruise: Into the Wild Amazon -----	p 8-9
Booking Info-----	p 10
The Motor Yacht Tucano-----	p 11-13
Hotel Info-----	p 13
Transfers / City Tours-----	p 15
How to Please Travelers? It's Expectations!----	p 15-16
Download Photos, Videos, Brochures-----	p 15
Sustainability-----	p 10
Health and Safety - Tucano Safe Zone-----	p 18

## Our Amazon Cruises are Really Different - How?

### **Expeditions, True / Go Farther, Go Deeper, Go For It!**

We explore deep into a UNESCO World Heritage site - the only boat! Our guests have experiences that few people ever will... in their entire lives.

### **Small Groups, (again!): Just Us and the Howling Wilderness**

Our groups are really small, usually just eight people per guide. Small groups are the *only* way to truly observe nature.

### **Excursions, Active and Authentic: Make Every Day Count**

We have many excursions every day: by launch, kayak, walks in the rainforest, fishing for piranhas, swimming, or just strolling through small, remote, and unspoiled villages.

### **Our Guides: Our Motto is "Look and Listen"**

Our guides are deeply skilled naturalists helping us observe the bizarre creatures of the wild wilderness.

### **Wait, There's more!**

#### **Comfortable, Elegant: Relax and Restore**

The *M/Y Tucano* is nimble, smart, stylish, and elegant. Travelers enjoy wonderful cuisine and comfort as we explore far into the wild rainforest. With our Egyptian cotton linens and French soaps and shampoos, we voyage in style.

#### **Style, Brasil!: There's nothing like It!**

Brasil: it's fun, passionate, friendly, and relaxed. Our traditions from Portugal, Europe, Japan, China, and Africa have made us warm, open, talkative, and personal. Just mix in lush vegetation, exotic wildlife, and stunning scenery, and the result is .... poetry.

#### **Companions in Adventure: Our Travelers Are the Best!**

Our travelers are really interesting. They come from all over the world to feel the romance, the beauty, and the thrill of the Amazon. Your travelers will be in good company.

#### **Sustainable: We Go With Nature... All the Way**

The *M/Y Tucano* is the only vessel with solar powered refrigeration, electric motors, solar heated showers, and solar ice makers. We try to preserve the place that thrills and inspires us... and our guests. We were awarded the distinction of the most sustainability operator in Latin America e Latin America Travel Association!



## Travelers Love our Cruises!

**Because they are personal and authentic.** There is nothing generic about our tours. The Amazon is our life. We love to share the astonishing beauty of this iconic destination with the warmth that is such an important part of Brazilian culture.

**Travelers can Choose! There is something for everyone.** Our guests can choose what kind of experience they want. It can be a comfortable leisure cruise simply of enjoying the exotic flora and fauna of the rainforest, or for the energetic, it can be a rigorous expedition into the howling wilderness.

**Brasil is the place to be!** The area we explore has some of the greatest diversity on Earth. That is why it is a UNESCO Natural World Heritage site. At any time of year we can walk, hike, kayak, and explore deep in the forest. And because it is one of the least inhabited places on the entire planet, the creatures for which the Amazon is legendary still thrive here.

**Because the tours are just plain fun.** What makes the *Tucano* experience fun are the small groups, the choices of activities, the very comfortable vessel, the deeply skilled guides, and the friendly and professional cruise staff. All this adds up to a great vacation and a truly, once in a lifetime experience.



## See you at the Rendezvous!

Our new departure / arrival lounge, the *Tucano Rendezvous*, is a place for travelers to meet and relax before and after our cruises. It is within our **Tucano Safe Zone** where we carefully apply health and safety precautions. It's a nice place to gather together with refreshments and take our comings and goings at a leisurely pace.

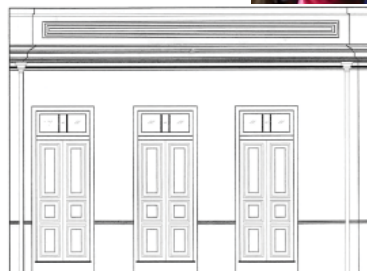

FACHADA, Av. Sete de Setembro, 208, Centro Histórico, Manaus

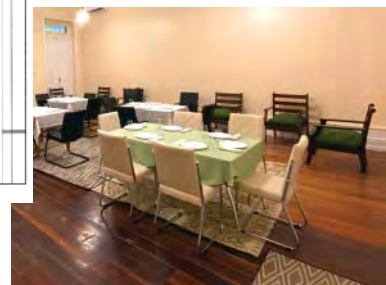

Confidential Cruise Tariff

**(1) Six Night Cruise: *Voyage to the Heart of the Amazon***

This is the most exploratory cruise in the entire Amazon - and is the Amazon's only true *expedition cruise*. We venture along hidden uninhabited rivers deep into the wild woods where the magnificent plants and animals of the rainforest reign supreme. There are many active excursions into the forest. By day and by night we seek out the mysterious life that stirs in this vast wilderness forest. The *Motor Yacht Tucano* is comfortable and nimble and enables us to voyage far up the least inhabited major river in the Amazon Basin: The Rio Negro. We venture farther than any other visitors into the UNESCO Natural World Heritage site, the *Central Amazon Conservation Complex*.

With our small group, our skilled naturalist guides, and our expedition itinerary, we observe creatures almost never seen by other visitors. Far off the beaten path, we also visit small villages where the rhythms of life are tuned to the cycles of the wilderness. On the last day of the cruise we visit the Encontro das Aguas, the confluence of the world's two largest rivers, the Rio Negro and the mighty, magnificent, Amazon River itself.

This experience is well beyond any ordinary cruise and way off the grid - the quintessential Amazon expedition cruise

**Where This Trip Begins and Ends**

**Embark**

Day 1, Saturday, 07:30am: Meet at the departure / arrival lounge, *Tucano Rendezvous*, 208 Sete de Setembro, Praça Dom Pedro II, Centro, Manaus. Following check-in, health screening, and baggage sterilization, travelers will be transferred to the *M/Y Tucano*. The *Tucano Rendezvous* is open on departure days from 06:00am until embarkation. Pre-boarding of the vessel is not permitted. Complementary transfer to meeting point: At 07:00am, by pre-arrangement, transfers to the *Tucano Rendezvous* are provided from two hotels: the Hotel Juma Opera and the Hotel Villa Amazonia. These transfers must be arranged at least 7 days prior to departure. Travelers that are not staying at either of these hotels must proceed directly to the *Tucano Rendezvous*.

**Disembark**

Day 7, Friday, 07:30am: Depart the vessel and transfer to the departure / arrival lounge, *Tucano Rendezvous*, located at 208 Sete de Setembro, Praça Dom Pedro II, Centro, Manaus. Unless other arrangements are made, this is the end of services. On the day of disembarkation the *Tucano Rendezvous* is open from 06:00-15:00 hours (06:00am - 3:00pm).  
 Early Disembarkation: Due to port regulations, early disembarkation is permitted only by pre-arrangement and when accompanied by staff members of the *M/Y Tucano*.  
 Post-Cruise Hotel Transfers: On disembarkation at the end of the cruise, travelers staying at the Hotel Juma Opera or the Hotel Villa Amazonia will be transferred to their hotel without expense. Travelers with evening flights are highly recommended to book a hotel for this day to avoid long waits at the airport.

**Departure Dates: *Voyage to the Heart of the Amazon* (6N / 7D)**

**2021 Cruise Dates:** May 29-Jun 04, Jun 12-18, Jun 26-Jul 02, Jul 10-16, Jul 24-30, Aug 07-13, Aug 21-27, Sep 18-24, Oct 02-08, Oct 16-22, Oct 30-Nov 05, Nov 13-19, Dec 04-10, Dec 18-24  
**2022 Cruise Dates:** Jan 15-21, Jan 29-Feb 04, Feb 12-18, Feb 26-Mar 04, Mar 05-11, Mar 12-18, Apr 02-08, Apr 16-22, May 07-13, May 21-27, Jun 04-10, Jun 18-24, Jul 02-08, Jul 16-22, Jul 30-Aug 05, Aug 13-19, Sep 03-09, Sep 17-23, Oct 01-07, Oct 15-21, Oct 29-Nov 04, Nov 12-18, Nov 26-Dec 02, Dec 10-16, Dec 24-30  
**2023 Cruise Dates:** Jan 07-13, Jan 21-27, Feb 04-10, Feb 18-24, Mar 04-10, Apr 01-07, Apr 15-21, May 13-19, May 27-Jun 02, Jun 10-16, Jun 24-30, Jul 08-14, Jul 22-28, Aug 05-11, Aug 19-25, Sep 09-15, Sep 23-29, Oct 07-13, Oct 21-27, Nov 04-10, Nov 18-24, Dec 09-15, Dec 23-29



<b>Individual Cruise Rates 2021 / 2022: <i>Voyage to the Heart of the Amazon</i> (6N/7D)(per person, usd)</b>	<b>Rack (Gross) Rate</b>	<b>Agent Net Rate</b>
Green Category Double Staterooms	\$3,150	\$2,520
Yellow Category Double Staterooms	\$4,665	\$3,732
Blue Category Single Staterooms	\$4,665	\$3,732

<b>Private Voyages Rate 2021 / 2022: <i>Voyage to the Heart of the Amazon</i> (6N /7D)(full boat reservation, usd)</b>	<b>Net Rate</b>
In Private Voyages the vessel is fully reserved for the exclusive use of a private group according to the published itinerary. In Private Voyages there are 8 cabins available for a maximum of 16 travelers. The net rate includes the services of individual voyages and is not commissionable. Booking conditions are outlined in the section: <i>Booking Conditions for Amazon Cruises</i> . Departure dates are subject to availability and rates subject to change without notice.	\$42,000



Confidential Cruise Tariff  
**(2) Four Night Cruise: *Into the Wild Amazon***

This cruise pushes beyond the limits of typical tours and beyond the boundaries of human settlement to explore remote rainforest. Over four nights the expedition cruise *Into the Wild Amazon* takes travelers into the dense forests and small tributaries within the UNESCO Natural World Heritage Site, *The Central Amazon Conservation Complex*. With our small group of adventurers, our very experienced naturalist guides, and our deeply capable exploration crew, we venture into one of the richest areas of the planet.

We also visit isolated villages to see what life is like living on the edge of the greatest wilderness on Earth. On the last day of the cruise we visit the Encontro das Aguas, the confluence of the world's two largest rivers, the Rio Negro and the mighty, magnificent, Amazon River itself.

In a brief amount of time, *Into the Wild Amazon* provides an experience of the essence of Amazon nature.

**Where This Trip Begins and Ends**

**Embark**

Day 1, Monday, 11:30am: Meet at the departure / arrival lounge, *Tucano Rendezvous*, 208 Sete de Setembro, Praça Dom Pedro II, Centro, Manaus. Following check-in, health screening, and baggage sterilization, travelers will be transferred to the *M/Y Tucano*. The *Tucano Rendezvous* is open on departure days from 06:00am until embarkation. Pre-boarding of the vessel is not permitted. Complementary transfer to meeting point: At 11:00am, by pre-arrangement, transfers to the *Tucano Rendezvous* are provided from two hotels: the Hotel Juma Opera and the Hotel Villa Amazonia. These transfers must be arranged at least 7 days prior to departure. Travelers that are not staying at either of these hotels must proceed directly to the *Tucano Rendezvous*.

**Disembark**

Day 5, Friday, 07:30am: Depart the vessel and transfer to the departure / arrival lounge, *Tucano Rendezvous*, located at 208 Sete de Setembro, Praça Dom Pedro II, Centro, Manaus. Unless other arrangements are made, this is the end of services. On the day of disembarkation the *Tucano Rendezvous* is open from 06:00-15:00 hours (06:00am - 3:00pm).  
 Early Disembarkation: Due to port regulations, early disembarkation is permitted only by pre-arrangement and when accompanied by staff members of the *M/Y Tucano*.  
 Post-Cruise Hotel Transfers: On disembarkation at the end of the cruise, travelers staying at the Hotel Juma Opera or the Hotel Villa Amazonia will be transferred to their hotel without expense. Travelers with evening flights are highly recommended to book a hotel for this day to avoid long waits at the airport.

**Departure Dates: *Into the Wild Amazon* (4N / 5D)**

**2021 Cruise Dates:** Jun 07-11, Jun 21-25, Jul 05-09, Jul 19-23, Aug 02-06, Aug 16-20, Sep 13-17, Sep 27-Oct 01, Oct 11-15, Oct 25-29, Nov 08-12, Nov 22-26, Dec 13-17, Dec 27-31

**2022 Cruise Dates:** Jan 10-14, Jan 24-28, Feb 07-11, Feb 21-25, Mar 07-11, Mar 21-25, Apr 11-15, Apr 25-29, May 16-20, May 30-Jun 03, Jun 13-17, Jun 27-Jul 01, Jul 11-15, Jul 25-29, Aug 08-12, Aug 22-26, Sep 12-16, Sep 26-30, Oct 10-14, Oct 24-28, Nov 07-11, Nov 21-25, Dec 19-23

**2023 Cruise Dates:** Jan 16-20, Jan 30-Feb 03, Feb 13-17, Feb 27-Mar 03, Mar 13-17, Apr 10-14, Apr 24-28, May 08-12, May 22-26, Jun 05-09, Jun 19-23, Jul 03-07, Jul 17-21, Jul 31-Aug 04, Aug 14-18, Sep 18-22, Oct 02-06, Oct 16-20, Oct 30-Nov 03, Nov 13-17, Nov 27-Dec 01, Dec 18-22



<b>Individual Cruise Rates 2021 and 2022: <i>Into the Wild Amazon</i> (4N/5D) (per person, in usd)</b>	<b>Rack (Gross) Rate</b>	<b>Agent Net Rate</b>
Green Category Double Staterooms	\$1,750	\$1,400
Yellow Category Double Staterooms	\$2,600	\$2,080
Blue Category Single Staterooms	\$2,600	\$2,080

<b>Private Voyages Rate 2021 / 2022: <i>Into the Wild Amazon</i> (4N/5D) (full boat reservation, usd)</b>	<b>Net Rate</b>
In Private Voyages the vessel is fully reserved for the exclusive use of a private group according to the published itinerary. In Private Voyages there are 8 cabins available for a maximum of 16 travelers. The net rate includes the services of individual voyages and is not commissionable. Booking conditions are outlined in the section: <i>Booking Conditions for Amazon Cruises</i> . Departure dates are subject to availability and rates subject to change without notice.	\$23,600



**(3) Voyage to the Heart of the Amazon (6 Nights)**  
**A True Expedition Cruise**

Description: *Voyage to the Heart of the Amazon* is different from all other cruises offered in the entire Amazon. It is a true "expedition cruise". We go far, far into the forest and are able to see creatures that are hidden to other visitors. We explore some of the most untouched rainforest in all of the Amazon. The voyage begins in Manaus, Brasil, and the *Motor Yacht Tucano* navigates far up the *Rio Negro* [pronounced NAY-GRO]. In the daytime, and often at night, we seek out the wildlife that still lives in the world's greatest wilderness. There are very few settlers so the plants and animals are still abundant.

Voyages on the *M/Y Tucano* are quite active with four or five excursions off the vessel every day. Together with our naturalist guides we get out into the forest and explore---not simply watch from the deck of the vessel. There are daily walks in the forest and we scout the small streams that branch off the main river using our electric powered launches or optionally by kayak. Some days we swim off deserted beaches in water as refreshing as rainwater. We are always treated to vistas of wild rainforest stretching as far as the eye can see.

On our excursions into the rainforest we observe magnificent plants of every imaginable shape and size. We listen to the exotic calls of birds and mammals and watch them from a forest trail or while scouting the river's edge in our launches. In the evenings we have a brief discussion about the creatures that we observed and the extraordinary ways in which the plants and animals have evolved to live in this ancient rainforest. Some nights we explore the river's edge in our launches and with spotlights we see caiman, close relatives of crocodiles.



Our basic navigation plan is to explore upstream northwest on the *Rio Negro*, as far as a major river called the *Rio Jauaperi*, about 200 miles from Manaus, Brasil. Along the way we explore many small tributaries where the forest is wild and undisturbed. Our journey

**The Rio Negro**

**Itinerary Sketch - 6 Nights**

- Day 1 Depart Manaus, Brasil and voyage north on the Rio Negro to the Rio Apuaú
- Day 2 Explore the giant lake inside a river island, Lago Turia
- Day 3 Lago Buriti
- Day 4 Scout the Rio Jauaperi
- Day 5 Explore the west bank of the Rio Negro
- Day 6 Cruise the Amazon River and the Encontro das Aguas, the confluence of the Amazon River and The Rio Negro.
- Day 7 Return to Manaus, disembark early morning.

**The Amazon River**

takes us to many different rainforest habitats which allows us to see a great diversity of wildlife.

On the last day of the voyage we travel to the "Encontro das Aguas", the meeting of the waters of the world's two largest rivers: The *Amazon River* and the *Rio Negro*. The light colored water of the Amazon and the dark water of the Negro do not readily mix and the two rivers flow side by side for many miles.

**UNESCO Natural World Heritage Site**

*Voyage to the Heart of the Amazon* explores some of the most untouched rainforest in all of the Amazon. The *M/Y Tucano* is the only vessel that explores far into the world's largest Amazon reserve and the only expedition cruise in a UNESCO Natural World Heritage Site: *The Central Amazon Conservation Complex*. This reserve is the largest in the Amazon with six million hectares of uninhabited wilderness. Roaming these trackless forests are all of the creatures that have made the Amazon the object of myth and legend. Along the *Rio Negro* there are only a few small settlements large enough to be considered towns. It remains a true wilderness. <http://whc.unesco.org/en/list/998>



This cruise is the quintessential and truly superlative expedition cruise of the wilderness Amazon. We explore beyond the tangle of vines and limbs along the river banks and experience the primal forest where the forces that shape plant and animal evolution continue on as they have for millions of years.

Please note that our cruises are exploratory and we adapt the vessel course to maintain an interesting cruise. But this does not diminish the cruise, instead it allows us to improvise and seek interesting places to explore.

#### (4) Itinerary: Voyage to the Heart of the Amazon (6 Nights)

**Day 1** Early this morning all guests board the vessel the *Motor Yacht Tucano* and depart upstream on the Rio Negro. Through the morning we will cruise through the world's largest river island system, the Anavilhanas Archipelago. From the observation deck we scan the magnificent tangle of vegetation at the water's edge. By mid-afternoon the vessel has gone beyond the frontier of settlement and entered a wilderness area. Both shores are covered by dense rainforest. Though we cannot predict what we will see, we likely observe pink river dolphins, primates and a large collection of exotic birds. Most certainly we will be treated to magnificent forest vistas and the spectacular trees themselves. In the late afternoon we embark in the launches and hunt for wildlife. We may also go for a swim in some of the world's most clean and refreshing water. (LD)

**Day 2** Early this morning we divide into small groups and explore the rainforest in our launches or kayaks, each group with a naturalist guide. We should hear and perhaps see howler monkeys accompanied by a morning serenade of toucans. After breakfast we go for a walk in the forest where we will get a good start on understanding Amazon ecology.

Around midday we return for lunch and the vessel will get underway, perhaps stopping at a place to swim.

In the late afternoon we will again explore the forest in our launches and listen to the sunset chorus of birds, frogs and howler monkeys. (BLD)



**Day 3** This morning there will be an early exploration of the waking forest. We will keep our eyes open for sloths... on most trips

we see them often. We return for breakfast followed by either a walk in the forest or an excursion in the launches. The *M/Y Tucano* will travel during the middle of the day and we stop in the afternoon for an excursion. Tonight the vessel may travel a bit more as we marvel at the night sky crowded with stars. (BLD)

**Day 4** After our morning excursions The *M/Y Tucano* will navigate along the heavily forested shore, scouting for wildlife. We may stop for a visit at a settler's home carved out of the forest. In the early afternoon we will be near an extraordinary river called the Rio Jauaperi. Here we will see a kind of forest known as the *varzea*. We will scout along the shoreline for some of the extraordinary creatures found only in this unique environment. This is often a good place to fish for the legendary scourge of the Amazon, Piranhas, which might just become hors d'oeuvres. Weather permitting, we will have a night excursion to observe nocturnal creatures. (BLD)



**Day 5** Today we will voyage to the west side of the Rio Negro and continue to scout in our launches and walk in the forest. Weather and water depth permitting, we will explore areas rarely visited by anyone else. Tonight the *M/Y Tucano* goes downstream, and will enter an east bank affluent of the Rio Negro and explore on deep into the rainforest on this small river. After our nocturnal exploration of the rainforest in our launches we return to the *Motor Yacht Tucano* for "Caipirinha Night" and perhaps try a bit of samba on the top deck. (BLD)



**Day 6** We begin the day with a dawn excursion hunting for wakening wildlife followed by a full Brazilian breakfast. We will then go one last time into the forest. In the mid-afternoon we will begin to journey downstream. We should arrive late in the day at the "Encontro das Aguas" - a stark, several-mile-long line where two of the world's largest rivers, the Amazon and the Rio Negro, join in a turbulent maelstrom. Here the dark water of the Negro runs beside the opaque brown water of the Amazon. At sunset the *M/Y Tucano* will once again turn her bows upstream on the Rio Negro and journey to our overnight anchorage. As we pass in front of Manaus, we will marvel at the scale of one of the world's largest and most vibrant port cities, over a thousand miles from the sea. Tonight we will have a farewell dinner and prepare for an early departure in the morning. (BLD)

**Day 7** Early this morning, after a hearty breakfast, all guests disembark from the *M/Y Tucano*. (B)

*Meal Codes: B = Breakfast, L = Lunch, D = Dinner*  
*Please note that the day-to-day schedule is approximate. The exact order of the days and specific features may be altered due to navigational and other scheduling considerations.*

*Degree of Difficulty: Good health is necessary. Guests can have a quite enjoyable trip by simply staying on board the *M/Y Tucano* and participating in launch excursions. Participants in our walks in the forest must be able to comfortably walk for two or more hours at a time.*

## (5) Into the Wild Amazon (4 Nights)

*The Wild Essence of the Amazon*

**Description:** This expedition cruise endeavors to capture the spirit and essence of the Amazon in a relatively short amount of time. We mostly voyage into the wilderness rainforest on one of the most magnificent rivers in the Amazon basin, *The Rio Negro*. Over three and one half days we walk in the forest, kayak on hidden streams, explore in our launches, and visit local communities along the edges of this wild and largely uninhabited river.

There are three or four excursions off the vessel every day. Early mornings we divide into small groups and glide along quiet channels in our launches or kayaks among giant rainforest trees draped with vines and orchids. The silence is broken only by the rustling of leaves by Squirrel Monkeys feeding or by the occasional piercing shriek of a Screaming Piha bird. During the day we walk in the forest and one day may visit a small riverfront community. Some nights we search for nocturnal creatures in our launches out in the star-filled darkness.

**Into the Wild Amazon** takes us to a variety of environments including dark flooded forests, the *igapó* and high forest, the *terre firme*, with towering trees and dense undergrowth. On lazy afternoons we may fish for the famous Amazon resident, the Piranha, some of whom we may see again on an appetizer plate. During our voyage we are treated to the ever-changing vistas of travel on the mighty Amazon River itself. Most travelers are astonished by the scale and grandeur of this majestic waterway that drains a continent.

On the cruise **Into the Wild Amazon**, we also experience the culture of the people who live in this vast wilderness. We will visit a small fishing village perched on the river bank where the traditional life is still guided by the rhythms of the rise and fall of the river. We may also visit the homestead of a family who make and grow almost everything they need. For many travelers these visits with local settlers, whose lives are so dramatically different from ours, are some of the most memorable experiences of the cruise.



Another fascinating visit is at one of the bustling river floating communities. Here a vibrant river trade continues as it has for centuries. The last evening of the cruise we will coast along one of the greatest ports in the world, the *Porto de Manaus*. At our farewell dinner we will have the opportunity to reflect on our extraordinary experience and offer a toast to one of the most remarkable places on Earth.

## Into the Wild Amazon

### Itinerary Sketch - 4 Nights

Day 1 Mid-day depart Manaus and voyage north on the Rio Negro. We voyage this afternoon through one of the world's largest island systems, the Anavilhanas Archipelago.

Day 2 Several daily excursions into the rainforest during from the early morning and well into the night.

Day 3 Excursions into the forest by foot, launch and kayak during the day. Tonight we travel downstream toward the Amazon River.

Day 4 After morning excursions, in the afternoon voyage to the meeting of the world's two greatest rivers: the Amazon River and The Rio Negro. In the evening cruise upstream on the Rio Negro.

Day 5 Early morning we disembark.

Please note that our cruises are exploratory and we adapt the vessel course to maintain an interesting cruise. But this does not diminish the cruise, instead it allows us to improvise and seek interesting places to explore.

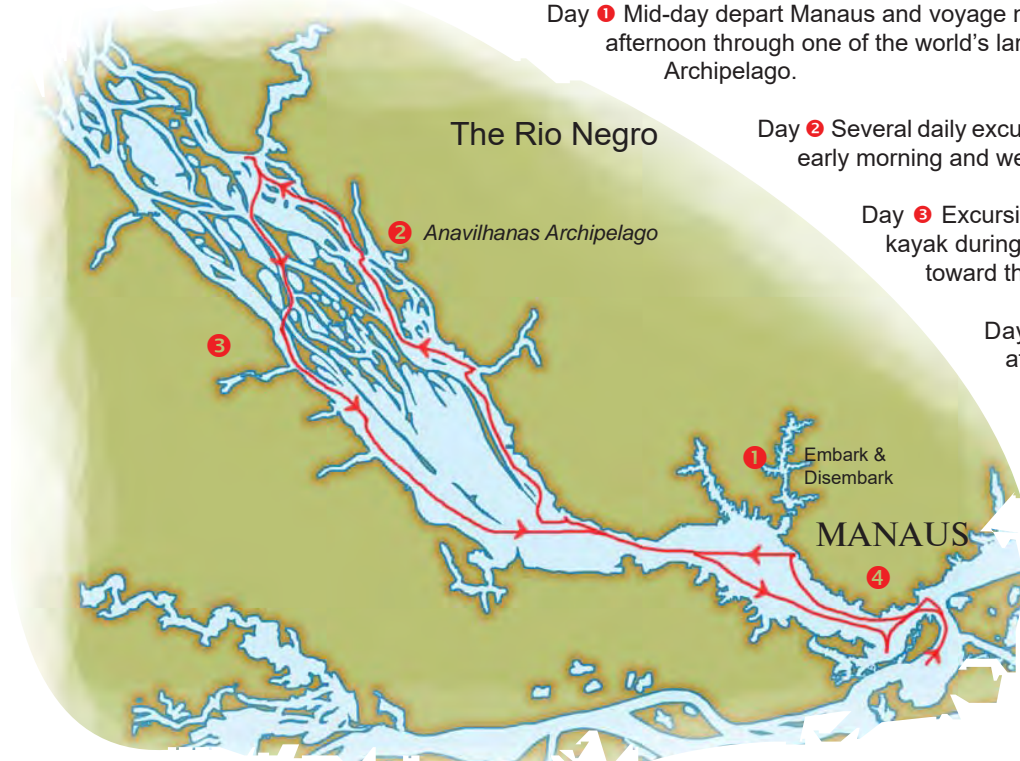

The Amazon River



## (6) Itinerary: Into the Wild Amazon, (4 Nights)

Day 1 This afternoon we embark on the *Motor Yacht Tucano* in Manaus, Brasil. We depart on the *Rio Negro* and as the vessel glides upstream over lunch we will have our first talk about Amazon environments. By late afternoon we enter one of the world's largest river island systems, the *Anavilhanas Archipelago*. The boat will weave along a winding channel with rainforest on both sides in a riot of brilliant vegetation. Weather permitting, we will go for a launch excursion in the gnarled and dense flooded forest along the river's edge. We may see some Squirrel Monkeys and we may hear the other-worldly growls of Howler Monkeys echoing through the primitive rainforest. The Amazon has one of the greatest collection of birds in the world and we are sure to see some of these brightly colored jewels perched in the treetops.



We return to the *M/Y Tucano* for hors d'oeuvres on the observation deck and a toast to the rainforest sunset. Following dinner we will embark in our launches in search of nocturnal creatures such as the Caiman, the Amazon's crocodilians. We may also see one of the large night birds such as a Great Potoo, with its bulging eyes and large mouth, adapted to swallow the huge Mariposa Moths. (LD)

Day 2 Shortly after sunrise this morning we explore the Anavilhanas Archipelago, a reserve that includes the world's largest system of river islands and also areas of tall dense rainforest. Here we will see the strange environment called the *igapó*, the black water flooded forest, where dense forests grow right out of the dark water of the Rio Negro. Mid-morning we return to the vessel for a hearty Brazilian breakfast. After some time to relax, weather permitting, we will disembark at mid-morning and dividing into very small groups we will go for a walk in the type of rainforest known as the *terra firme*. Here we have a good chance to see the markings, if not the animals themselves, of some of the Amazon's great mammals like peccaries (wild pigs) or even a jaguar.

Around mid-day we return to the vessel for lunch and a siesta. In the afternoon we will excursion in our launches along the edges of the dense forest and listen to the sunset chorus of birds, howler monkeys, and frogs. Weather permitting, tonight we will have an excursion to spot caiman (the Amazon's crocodiles) and other nocturnal creatures. We very often see arboreal porcupines or sloths scrambling high in the limbs. (BLD)

Day 3 Today we will voyage to the west side of the Rio Negro and continue to scout in our launches and walk in the forest. We will explore, according to the weather and water depth, areas rarely visited by anyone else. Tonight the *M/Y Tucano* goes downstream, and river depth permitting, will enter an east bank affluent of the Rio Negro and explore on deep into the rainforest on this small river. After our nocturnal exploration of the rainforest in our launches we return to the *Motor Yacht Tucano* for "Caipirinha Night" and perhaps try a bit of samba on the top deck. (BLD)

Day 4 We begin the day with a dawn excursion hunting for wakening wildlife followed by a full Brazilian breakfast. We will then go one last time into the forest. In the mid-afternoon we will begin to journey downstream to arrive late in the day at the "Encontro das Aguas" - a stark several mile long line where two of the world's largest rivers, the Amazon and the Rio Negro, join in a turbulent maelstrom. Here the dark water of the Negro runs beside the opaque brown water of the Amazon. At sunset the *M/Y Tucano* will once again turn her bows upstream on the Rio Negro and journey to our overnight anchorage. As we pass in front of Manaus, we will marvel at the scale of one of the world's largest and most vibrant port cities over a thousand miles from the sea. Tonight we will have a farewell dinner and prepare for an early departure in the morning. (BLD)

Day 5 Early this morning, after a hearty breakfast, all guests disembark from the *M/Y Tucano*. (B)

*Meal Codes: B = Breakfast, L = Lunch, D = Dinner*  
*Please note that the day-to-day schedule is approximate. The exact order of the days and specific features may be altered due to navigational and other scheduling considerations.*

*Degree of Difficulty: Good health is necessary. Guests can have a quite enjoyable trip by simply staying on board the M/Y Tucano and participating in launch excursions. Participants in our walks in the forest must be able to comfortably walk for two or more hours at a time.*



## (7) Booking Conditions for Amazon Cruises

**Prices Include:** Prices are per person in usd. Prices include accommodations, guided excursions, and meals as indicated in the itinerary. Bottled water is served free of charge. Guests are provided a complementary aluminum water bottle and a very stylish straw hat! With advance notice, on Day One, passengers may join the group on a complementary transfer from the recommended hotels to the arrival / departure lounge, the *Tucano Rendezvous*. At the end of the cruise, a second complementary transfer is provided from the disembarkation point to the same recommended hotels or to the *Tucano Rendezvous*. Cruise prices and itineraries are subject to change without notice.

**Prices Do Not Include:** Not included are airport transfers, soft drinks, or alcoholic beverages, gratuities, if any, or items of a personal nature.

**Deposit:** For individual travelers, the guarantee of a deposit of \$300 usd per passenger is required to confirm the reservation. For Private Voyages, the deposit amount \$3600 usd regardless of the number of travelers. Deposits are non-refundable even if the passenger cancels. Deposits are not transferable.

**Stateroom Categories:** There are three categories of staterooms on the *M/Y Tucano*. All have a private bathroom and air-conditioning. Please see more full descriptions of the categories on pages 11-13.

**Triple Occupancy:** Three travelers can share stateroom "0". Each traveler in triple occupancy pays the Green Category rate.

**Single Occupancy:** If a single traveler is willing to share with another same gender passenger, he or she will be charged the Green Category rate, even if a roommate is not available. Single travelers that request a private stateroom are charged the Blue Category rate. If a single traveler wishes to reserve a Yellow Category stateroom, the fare for two travelers rate is applied.

**Discounts for Children:** Children 12 years of age and under who share a room with an adult receive a discount of 50% off the cruise rate.

**Notes:** Rates are subject to change without notice. In case of *force majeure*, to include unexpected repairs, Amazon Nature Tours reserves the right to substitute a vessel similar to the *Motor Yacht Tucano* without penalty.

## (8) Payment Terms

a) **Deposit:** Once a Individual traveler reservation is confirmed, a non-refundable deposit in the amount of \$300 usd per passenger is considered owed. On confirmation of Private Voyages, a deposit in the amount of \$3,600 is due. These deposits are non-refundable even if the passengers were to cancel.

b) **Balance of payment:** due 60 days before the cruise departure.

## (9) Commissions

The Individual Cruise net rates are based on a commission of 20% to your company. Private Voyage net rates are not commissionable. Rates for optional land services are based on a 10% commission. Please note that all rates are subject to change without notice.

## (10) Cancellation and Refund Policy

Payments can be made by agency check, bank check, money order, or wire transfer. Cancellation policies for Individual or Private Voyages are the same. They must be made in writing. If cancellation is received 61 days prior to departure, all payments will be fully refunded except for the \$300 deposit per passenger. For cancellations received between 60 and 45 days before departure, fifty percent of the trip cost will be refunded.

For cancellations less than 45 days before departure, no refund will be able to be made. Failure to secure a valid passport, visa or air arrangements does not waive this refund policy. Inability to operate other side trips or schedule changes with side trips does not waive the refund policy. We strongly recommend that all passengers obtain travel insurance. Please note that reservations are not transferable.

## (11) How to Check Cruise Availability and Make Reservations - It's easy!

The best way to confirm availability or make a reservation is to send us an email. Alternatively, give us a call during the hours of 09:00am - 5:00pm, (UTC -5).

a) **Courtesy Hold:** A temporary hold can be placed on staterooms while arrangements are finalized for travelers. This courtesy hold does not require a deposit, but when the hold expires, the reservation is cancelled.

b) **Reservation:** When making a reservation, please provide passenger names as they appear on passports.

c) **Stateroom Category:** Which category of staterooms do the travelers prefer, Yellow, Green, or Blue? See below for descriptions.

d) **Single willing to share?:** If willing to share, then a traveler pays the Green Double rate for a Green stateroom.

e) **Hotel Nights:** Would the travelers like an optional hotel night prior to the cruise? **Two** nights are very strongly recommended!

f) **Transfers:** Optional airport transfers are done with a bilingual guide, a professional driver, and a commercial vehicle. We do not offer arrangements for guides to drive their private vehicles. When there are cruise travelers on the same flight, they are transferred together.

g) **City Tour:** Our city tours in small groups only for cruise travelers. They are operated by the same transfer staff.

h) **Pre-departure Booklet:** On confirmation, we send a non-branded digital pre-departure booklet called "Expedition Notes" that is full of helpful information that all travelers need before the Amazon cruise. Please send this to your travelers! We will also send a Passenger Info Form that requests information required by the Brazilian Navy for the vessel sail.

## O Brave New Tucano!

*Nimble, Smart, Stylish, and Elegant, the Amazon Expedition Small Ship*

### *New Spaces to Enjoy the Rainforest*

The *M/Y Tucano* has been substantially renovated. The staterooms were completely redone as was the main salon. And all of the expedition cruise activities were re-imagined to enable travelers themselves to choose how they will be exploring the depths of the Amazon rainforest.

We have made the exploration experience still more comfortable and elegant by thoroughly upgrading the accommodations and public spaces. There were countless small improvements to help the vessel stay new and inviting.



One of the most pleasurable of innovations are the glass panels in the salon that make the *M/Y Tucano* larger, brighter, and more stylish. Creating the glass walls presented a considerable engineering puzzle. We wanted to avoid turning the salon into an aquarium-style enclosure that would insulate the travelers from the rainforest; an enclosed space would not fit the vessel's commitment to sustainability.

The solution was a system of glass panels that actually *open and glide* into hidden pockets. Now, at certain times of day, the walls of the salon are opened and travelers enjoy the flower-scented breezes of the Amazon as well as experiencing an immediacy with the rainforest that cannot be had in an enclosed space. When the day becomes hot or we experience one of the magnificent torrential storms of the rainforest, we simply close the glass walls and enjoy the ever changing rainforest tableau in air-conditioned comfort.



### *Elegant and Sophisticated*

In order to enhance the feeling of elegance, the staterooms on the *M/Y Tucano* were fully refinished and redecorated. The decorative style is of a sophisticated yacht with polished brass and highly varnished wood panels, and this ambience was renewed with new fixtures and refinishing.

Many new artworks were commissioned for the vessel. To amplify the sense of style as well as to pamper the explorers, the stateroom amenities were also refashioned. The *M/Y Tucano* now features 700 thread count Egyptian cotton woven by Brasil's premier luxury manufacturer, **Artelassé**. Each stateroom also has a bit of France via shower kits by **L'Occitane**.

*Artelassé*  
A ARTE DE VIVER BEM

**L'OCCITANE**  
EN PROVENCE



### *Imagination + Authenticity*

*= Wonderful Experiences*

Finally, the most important renovation made in our project of renewal was the re-imagining of the *expedition cruise* experience. The many daily excursions into the rainforest were thoroughly reviewed and revised in order to satisfy the great range of interests that travelers bring to these expedition cruises. The *M/Y Tucano* has a commitment to enabling travelers to choose among different ways to experience the wilderness rainforest.

In the program re-imagining, these options were expanded so that travelers themselves can choose a leisurely expedition pace with the keen observations of our naturalist guides, or alternatively, they can venture out with our deep forest guides on rigorous full-on nature excursions of deep forest hikes or kayak explorations in remote rainforest streams. With many options to choose from, travelers can themselves actively engage in finding the most enjoyable, meaningful, and authentic way to enjoy the wonders of the greatest wilderness on earth.

## Deck Plans: The MOTOR YACHT TUCANO

Our trips are quite active. We spend much of our time off the vessel exploring the forest, but when we are on board, the *M/Y Tucano* offers space to comfortably spread out and contemplate the wonders of nature. With over seventy large windows, the vessel is bright and airy. Most of the windows open and have screens, so travelers can enjoy the blossom scented air of the rainforest. The staterooms and the salon are air-conditioned and have elegant raised wood panelling so that the adventurers can travel in style. In the deck plans below this symbol:  = windows. There are lots of them!



### Observation Deck

On this deck there is only one stateroom, number 0. This stateroom has a queen size bed and a single bed so it can accommodate three travelers. It is a large stateroom, but has a smaller bathroom.



Salon / Dining Room

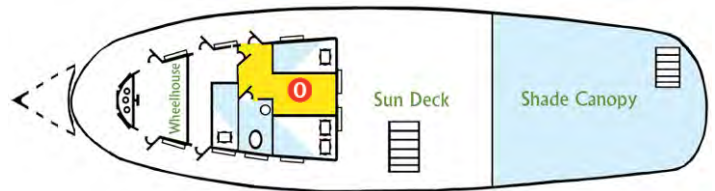

### Middle Deck

Staterooms 5 and 6 have two single beds side by side. Stateroom 7 has a bunk with a single mattress above and below. Stateroom 8 is a single stateroom which, on request, can be converted to a double stateroom.

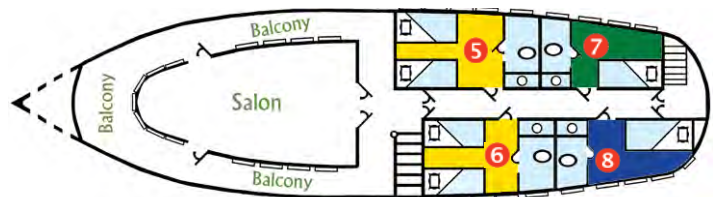

### Main Deck

Staterooms 3 and 4 have two single beds side by side. Stateroom 2 has a bunk with a single mattress above and below. Stateroom 1 is a single stateroom which, on request, can be converted to a double stateroom.

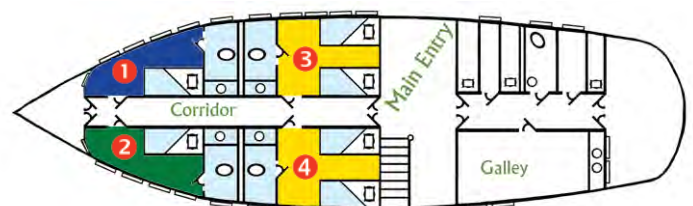

## Stateroom Categories

There are three categories of staterooms, all of which have large windows, private baths with sinks toilets and showers, and air-conditioning with individual controls.

*Yellow Category:* The five staterooms in this category are large and have beds side by side.

*Blue Category:* These two staterooms are singles, each with a single bed.

*Green Category:* The two Green staterooms have above and below berths (bunk beds).



### Yellow Category Staterooms

 The five double staterooms in this category are large and have beds side by side. They are numbered #3, #4, #5, #6, and #0. Stateroom #0 has a queen-size bed and a single bed. The Yellow Category beds can be converted into queen-sized beds.



### Blue Category (Single Staterooms)

 These staterooms, numbers #1 and #8, have a single twin bed. They are smaller than the Yellow staterooms, but have lots of windows and a large bathroom.



### Green Category Staterooms

 The double staterooms, #2 and #7, have above and below berths with single size mattresses. They are smaller than the Yellow staterooms, but are comfortable outside staterooms with large windows, private bathrooms, and air-conditioning.



### (13) Hotel Nights 2021

We strongly recommend that passengers spend at least one night, but preferably two nights, in Manaus prior to our cruises. Travelers should be rested and eager to embark on their adventure in the greatest wilderness on earth.

#### Hotel Juma Opera

The Hotel Juma Opera opened in 2020 and is situated directly beside the *Teatro Amazonas* the famed Opera House of the Amazon. There are 40 spacious rooms many of which overlook the opera house and the stylish plaza the *Largo São Sebastião*. The hotel's public spaces include a dining room and a swimming pool that overlooks the Opera House and the leafy plaza. Breakfast is included. Please note that there may be holiday black-out periods.

*Standard Patio View:* These 8 rooms vary in size from 260 - 300sf and are situated in the central part of the hotel and have either single or king size beds. Some rooms have connecting doors which can be ideal for families.

*Superior Patio View:* These 7 rooms vary in size from 345 - 420sf and are in the central part of the hotel. All have king size beds.

*Premium Theater View:* These 15 rooms vary in size from 250 - 300sf and are similar to the Superior Patio View but have a mixture of king or double beds. All these rooms have a view of the Opera House.

*Luxury Theater View:* These 8 rooms vary in size from 390 - 460sf and have an overlooking view of the Opera House

#### Low Season Rates, 2021 / Season: Feb - Jun (except national holidays)

2021 RACK (Gross) Rates (per pax per night in usd)					2021 NET Rates (per pax per night in usd)				
	Dbl	Sngl	Trpl	Quad		Dbl	Sngl	Trpl	Quad
Standard Patio View	\$65	\$105	\$60	n/a	Standard Patio View	\$58.5	\$94.5	\$54	n/a
Superior Patio View	\$75	\$110	\$65	n/a	Superior Patio View	\$67.5	\$99	\$58.5	n/a
Premium Theater View	\$80	\$125	\$75	n/a	Premium Theater View	\$72	\$112.50	\$67.50	n/a
Luxury Theater View	\$115	\$160	\$85	n/a	Luxury Theater View	\$85.50	\$144	\$76.50	n/a

#### High and Medium Season Rates, 2021 / Season: Jan, Jul - Dec, (except Dec 12-\*Jan, 01, '22 and national holidays)

2021 RACK (Gross) Rates (per pax per night in usd)					2021 NET Rates (per pax per night in usd)				
	Dbl	Sngl	Trpl	Quad		Dbl	Sngl	Trpl	Quad
Standard Patio View	\$75	\$130	\$65	n/a	Standard Patio View	\$67.50	\$117	\$58.50	n/a
Superior Patio View	\$85	\$145	\$75	n/a	Superior Patio View	\$76.50	\$130.50	\$67.50	n/a
Premium Theater View	\$95	\$155	\$80	n/a	Premium Theater View	\$85.5	\$139.50	\$72	n/a
Luxury Theater View	\$115	\$195	\$95	n/a	Luxury Theater View	\$103.5	\$175.50	\$85.50	n/a



#### Hotel Villa Amazonia

This boutique hotel is located in the historical center of Manaus within walking distance of the Teatro Amazonas, the famed Opera House of the Amazon. There are three categories of rooms which vary in size. All the rooms have king size beds or two twins, are air-conditioned, have complementary Wi-fi, fridges, electronic safes, and french balconies overlooking the central courtyard. The central courtyard has a small swimming pool and the hotel has a fitness center, a business center, and a restaurant. Most of the hotel rooms are Superior Category. Triple accommodation is by addition of a roll-away single bed. Please note that there may be holiday black out periods. Rates are subject to change without notice. Rates below include breakfast.

*Standard Suites:* Each of these five rooms has 280sf of space and a glass enclosed shower.

*Superior Suites:* Each of these twenty rooms has 335sf of space and a bath combined with shower.

*Premium Suites:* Each of these five rooms has 410sf of space, a second room, and a bath combined with shower.

#### Low Season Rates, 2021 / Season: Feb 17-Mar 31, Apr 05-Jun 01, Jun 07-30, Sep 01-Oct 07, Oct 17-Dec 16

2021 RACK (Gross) Low Season Rates (per pax per night in usd)					2021 NET Rates Low Season Rates (per pax per night in usd)				
	Dbl	Sngl	Trpl	Quad		Dbl	Sngl	Trpl	Quad
Standard Suite	\$95	\$145	n/a	n/a	Standard Suite	\$85.50	\$130.50	n/a	n/a
Superior Suite	\$95	\$160	\$70	n/a	Superior Suite	\$85.50	\$144	\$63	n/a
Premium Suite	\$110	\$210	\$85	n/a	Premium Suite	\$99	\$189	\$76.50	n/a

#### High Season Rates, 2021 / Season: Apr 01- 04, Jun 03- 06, July 01-Aug 31, Oct 08-16, Dec 17-Jan 01, '22 (3 day min)

2021 RACK (Gross) High Season Rates (per pax per night in usd)					2021 NET Rates High Season Rates (per pax per night in usd)				
	Dbl	Sngl	Trpl	Quad		Dbl	Sngl	Trpl	Quad
Standard Suite	\$100	\$180	n/a	n/a	Standard Suite	\$90	\$162	n/a	n/a
Superior Suite	\$110	\$200	\$90	n/a	Superior Suite	\$99	\$180	\$81	n/a
Premium Suite	\$145	\$260	\$110	n/a	Premium Suite	\$130.50	\$234	\$99	n/a

#### (14) Airport Transfers, Escorted Private (Optional)

Our optional airport transfers are escorted with a bilingual guide, a driver, and a commercial vehicle. We do not use guide-driven private cars. Rates are per person, per transfer in usd subject to change without notice.

##### 2021-2022 Escorted Private Transfers:

Rack Rates Per Pax		Net Rates Per Pax	
1	2 - 4	1	2 - 4
80	40	72	36

#### (15) City Tour of Manaus, 2021-2022 (Optional)

This three hour tour of Manaus is available at the end of the cruise and is operated by our staff. It includes the boisterous *Mercado Municipal of Manaus*, the *Teatro Amazonas* - the famed opera house of the Amazon, and the historical birthplace of Manaus, the *Praça Dom Pedro II*. Included are the services of a bilingual guide, entrance fees, and transportation to and from the *Tucano Rendezvous*. Please note that most museums are closed holidays.

RACK Rate per Pax, usd: 80      NET Rate per Pax: 72

#### (16) Airline Connections to Manaus

Manaus is the most readily accessible city in the entire Amazon. There are direct international flights and many connecting flights via the vast airline system within Brasil and South America.

##### European Travelers

There are many direct flights from Europe to Brasil which enable travelers to combine several destinations within Brasil. Within Brasil there are many domestic carriers connecting to Manaus.

##### North American Travelers

When returned to normal service, there should again be four air carriers with direct service to Manaus.

- a) *American Airlines*: daily direct nonstop from Miami to Manaus.
- b) *LATAM Airlines*: daily direct nonstop from Miami to Manaus.
- c) *COPA Airlines*: direct flights to Manaus from Panama City originating in Lima, Guayaquil, New York, Miami, Los Angeles, and many other major cities in Latin America.
- d) *GOL Airlines*: weekly from Orlando, Florida.

##### From Other countries in South America

There are dozens of daily flights to Brasil from other countries in South America which facilitate flight itineraries that include several destinations. Among these are flights on LAN Airlines from Lima, Peru, on COPA Airlines from Panama City, from Cusco in Peru as well as Buenos Aires, Argentina, and Caracas, Venezuela.

#### (17) Visas

Most travelers with European passports do not need tourist visas to enter Brasil. Travelers from the United States, Canada, Australia and Japan no longer need visas!

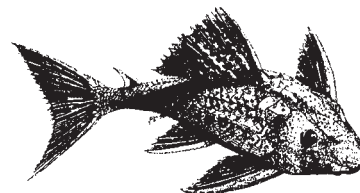

#### (18) Electricity and Conservation

The electrical system on board the *M/Y Tucano* is 110 volt / 60 cycle alternating current. In the interests of conservation, in the morning and for a short time in the afternoon, we turn off the diesel generators and all other noise-making machinery which includes the air-conditioning system. This is a good time to appreciate the wonderful stillness of the wilderness and the subtle natural sounds of the forest. For more information the section below: *Sustainability*.

#### (19) Photos, Videos, and Brochures

Please Use Them! There are instructions below to download images and videos for promoting cruises on the *Motor Yacht Tucano*! They can be used without copyright. But please use the images only in the context of describing our Amazon cruises on the *Motor Yacht Tucano*.

Videos can be either downloaded and reside on your company's server or video **links** from the **YouTube** server can be embedded on your site. This allows the videos to be played in your website but stored on the Youtube server. Please consult *YouTube* about installation instructions.

##### Download Photos and Video from Dropbox

- a) Follow the link below to our Dropbox account. This will open to a page of folders:  
[https://www.dropbox.com/sh/whzf79m97107m7p/AACWjM\\_v6A7EIIUkXvmuGvUVa?dl=0](https://www.dropbox.com/sh/whzf79m97107m7p/AACWjM_v6A7EIIUkXvmuGvUVa?dl=0)
- b) Browse the folders. Click on any image to display a larger image. Use arrow keys to go to next image.
- c) To download an image or video, go to the top right of the screen and click on the Download button.

#### (20) How to Please Travelers?

It's all about expectations. Here are some typical questions.

The very best way to have satisfied customers is to thoroughly inform about the character of the tour program. A well informed traveler has appropriate expectations and is able to relax and enjoy the experience. Below are some tips on what travelers can expect on our cruises. Be sure that all travelers receive copies of our pre-departure booklet "*Expedition Notes*"! A prepared passenger is happier!

##### Are these Luxury Cruises?

Our accommodations are very comfortable and elegant, but we do not aim for luxury accommodations or fine dining. What matters is the sophistication of the narrative, the story we tell, the activities in the forest, and the authenticity of the experience. Our vessel is designed to provide exceptional and extraordinary experiences with very comfortable, but not fancy, accommodations. We cater to a discerning clientele. We strive to offer tour operators and travelers a sophisticated and very elegant ship-board experience and an exceptional field experience at a reasonable price.

### Is this an active program?

The program is a quite active trip, but is also as relaxing as our guests prefer. Guests can choose! We navigate the *M/Y Tucano* mostly in the middle of the day and at night, which leaves us lots of time to explore off the vessel in the rainforest. For guests who want an active program there are several hours spent exploring every day. We have optional kayak excursions where we thread deep into the flooded forest. For those travelers that prefer a more leisurely but engaged experience, they simply choose from among the many daily excursions. It is an interesting experience just being on the vessel because we are surrounded by wild rainforest.

### Will travelers see lots and lots of animals?

On our cruises we see lots of *kinds* of animals, because the Amazon has the greatest *diversity* of wildlife on Earth. But we usually see only a small number of creatures of *each* kind. The fantastic collection of creatures of the Amazon is spread out in the forest and the creatures actually *hide from us*. Often a good look at an animal will require binoculars. But these are wild creatures and not the semi-captive animals that are typically found in forest lodges or hotels.

We never know what we will see on a trip, but our cruises generally see many more creatures than other Amazon cruises because of the skill of our guides, the small groups, our wilderness destination, and the fact that we are dedicated to exploration. On our expedition cruise we often see about 100 different species of birds, 3-6 kinds of monkeys, 5-10 different reptiles and amphibians, about 5 or so other types of mammals like anteaters or otters, and a vast collection of some of the most interesting plants on Earth.

### Do travelers get a chance to go into the forest?

Absolutely, we have 3-5 excursions off the vessel every day. This is not a sedentary cruise where guests lounge most of the day, nor is it a cruise focused on fine dining or luxury accommodations. Actually, most of the nature portion of our voyage takes place off the vessel. We go walking in the forest every morning. We have several daily excursions in our launches or kayaks and we visit small villages or the homes of pioneer families. Several nights during the cruise, weather permitting, we also have excursions to observe nocturnal creatures.

### Travelers Choose the Experience!

An important aspect of cruises on the *M/Y Tucano* is that we give travelers choices of the kinds of activities. On the many excursions every day we divide into two groups, each with a different focus. Guests can choose to go with the *Science Group* which goes at a leisurely pace and focuses on the fascinating details of Amazon flora and fauna or, alternatively, they can go with the *Adventure Group* for a longer, much more vigorous exploratory experience hiking or in kayaks. In this way travelers of different interests and expectations can enjoy our activities in the way that they prefer and have the kind of experience that they will enjoy.

### Are these trips fun?

Of course the trips are fun! Our cruises are aimed at experiencing Amazon nature and the best kind of trip is good-humored, light-hearted, and dedicated to exploration. We try to be precise about nature and we enjoy ourselves at the same time. Weather and navigation permitting, we swim off pristine beaches. We also fish for piranha and sometimes they end up on our table. There is a cocktail hour on the top deck with *hors d'oeuvres* every evening and sometime during the trip we will have "*caipirinhas*", the famous drink of Brasil, accompanied perhaps by a bit of samba, or maybe even some dancing of the Amazon sizzling favorite, the *forró*.



### When is the best time to go?

The best time to travel to the Amazon is really dependent on a traveler's personal considerations. The key to observing wildlife is not when you travel, but rather the diligence of the guides and the guests, and a little bit of luck. We operate our expeditions all year round and the trips are wonderful any time of year.

Our trips take place in the very middle of the Amazon in the State of Amazonas, Brasil. It rains much less in the center of the Amazon than it does in the Peruvian end...as much as 30% less. The rainy season runs roughly from late January through early May. Though it can rain more in the rainy season, it is rare to have a full day of rain. There are even some advantages to traveling in this season. Most riverine plants fruit and flower in this period, and it is generally a bit cooler.

The dry / low water season runs from September to November and in this period the rivers begin to shallow and broad beaches of fine white sand appear. It often rains a bit in the afternoon in the dry season too. This is an excellent time to see large fishing birds, marine mammals, and at night, reptiles like Caiman, the Amazon's crocodiles. The months of October and November are drier and hotter and correspond to the lowest river levels of the year. Though some creatures will be less abundant in the dry season, others will fly or swim in to fill the void. We usually adapt the itinerary in these months to navigate the changing river channels and the broad beaches that appear at every turn of the rivers.

The *M/Y Tucano* mostly travels in the middle of the day and at night, which leaves the best hours to explore. But when we do travel, when practical, the vessel hugs the shore line and it is interesting to observe the nearby forest. We are constantly on the lookout for creatures which frequently congregate at the river's edge. Though we remain comfortable, we do not become insulated from the forest. The river is fascinating to watch since we often see large fish leaping, pink dolphins, countless birds, and strange gargantuan trees with hanging vines.

### About Amazon Nature Tours

We began operating ecological tours in the Brazilian Amazon in 1989, though we have worked in the Amazon since 1982. Our programs are the most intensive and thoughtful offered in the entire Amazon. We have conducted hundreds of expeditions, many with very-well known guests and scientific guides. Your travelers will find our trips fascinating.



## (21) Sustainability

The *M/Y Tucano* conducts the most sustainable cruises in the Amazon. There are three parts of our sustainability policy: staffing, tour operations, and ship management.

It's all about the people. On our cruises our staff has a vital role in sustainable tourism. It is not just that they themselves are committed to the environment, and it is not just that they are highly trained professionals, but crucially, they are members of our exploration team for many years. Our staff have long-term employment, not free-lance occasional positions, and in this way the benefits of ecotourism are shared. All of us have a commitment to sharing our knowledge of the rainforest with travelers in a sustainable way.

Tour operations on the *M/Y Tucano* are guided by very detailed "best practices" to protect the flora and fauna as well as help us in our relations with the traditional communities. Because our cruises voyage deep into the wilderness, we encounter rare wildlife and habitats that we are careful to avoid disturbing. All of our excursions off the ship are designed with conservation in mind. Many of our launch excursions are powered by electric motors. We optional have guided kayak excursions most mornings, we fish, we swim, we walk in the forest, and we do our best to enjoy the environment with as little impact as possible.

The *M/Y Tucano* was designed to operate as sustainably as possible and our ship management focuses on energy conservation, pollution control, and waste reduction. Energy consumption is especially important and the vessel has equipment and procedures that help us reduce consumption while at the same time ensuring comfort for our travelers. In order to reduce fuel use and emissions, the *M/Y Tucano* was built with **two** independent water systems: one operated by gravity and one by electricity. The gravity system is not pressurized and the water is heated by solar panels. The powered pressure system heats water with "on-demand" water heaters eliminating the need to heat water 24 hours per day. The power showers are operated at specific times of day.

The *M/Y Tucano* has a policy of "Solar Power Hours" for certain hours during the daytime. When they are not needed, we actually turn off all fuel consuming machines and what energy we use comes from our solar panels. This is generally in the morning and late afternoon when travelers are off the vessel on excursions. The vessel remains comfortable even without electricity because it was designed to offer water and illumination even without diesel generators operating. In Solar Power Hours the sinks, toilets, and the showers continue to function. Because the *M/Y Tucano* has large windows, travelers are able to use natural lighting during the day. All stateroom fixtures have LED lamps.



When it comes to climate control, the *M/Y Tucano* has an efficient air-conditioning system that functions in the heat of the day and at night. Even during the solar power hours, the staterooms stay cool because the vessel is thermally insulated. The stateroom windows open and close and have insect screens. Many travelers choose to entirely turn off the air-conditioning for the duration of the cruise. In ship management we employ hotel sustainability techniques such as changing the stateroom linens every other day instead of every day, unless requested by the travelers. We also avoid the use of disposable packaging, where possible, and recycle our waste in the city of departure, Manaus, Brasil.

Altogether, the combination of specialized equipment, conservation procedures, and responsible tourism practices enable us on the *M/Y Tucano* to operate as sustainably as possible. We do everything we can to not disturb the wild and lovely Amazon wilderness rainforest that we have the privilege of visiting.



One Solar Shower Head and One Fossil Fuel! - 

### Cultural Preservation

To be truly sustainable, travel must also be attentive to the impacts on local communities. We are very careful to only positively benefit the small communities that we visit - after all, we are from these communities. Our goal is to share the benefits of tourism in a positive and respectful way and to help preserve the natural environment by providing income from wild forest. We are all in this great mission together.



# The Tucano Safe Zone

## Health and Safety Summary

### *Maintaining the Zone*

To keep our travelers and crew members safe, we have developed procedures that guide every aspect of our cruise operations and shape the passengers' experience. We call it the Tucano Safe Zone. From airport transfers all the way to ship supply, every effort possible is taken to maintain a safe zone for our community. Above all, we consider it our duty to serve as advocates for travelers and staff before, during, and after the journey. Below are summarized some of the measures that we have taken to keep everyone safe and help travelers feel comfortable in exploring with us.

#### **Small Groups = Small Contacts**

The best possible nature experience is in a small group – and the safest. Normally our cruises are full when we have only 12-14 travelers. In our excursions into the forest, the groups are even smaller, usually less than 6-8 people. This preserves our zone by keeping the contact pool smaller. Our size also lends itself to Private Voyages so that a family or collection of friends travel in together.

#### **Departure Lounge and Health Screening**

To make sure that all travelers and staff members are healthy, we have built a new departure / arrival lounge for health screening prior to embarkation, the *Tucano Rendezvous*. The screening includes a health questionnaire, an interview, and also verification of vaccination. All staff members and travelers need to provide proof of vaccination prior to boarding the vessel. Baggage is cleaned and sterilized prior to transport to the vessel. The *Tucano Rendezvous* also serves as comfortable for our exploration community and is available at the end of the cruise for travelers to relax prior to outbound flights. Stay in the zone!

#### **Supply Security**

Fundamental to maintaining the safe zone is strict monitoring of people and materials entering the *M/Y Tucano* and the *Tucano Rendezvous*. Everyone that wishes to enter our safe zone, whether they be engine mechanics or cruise travelers, must undergo a health screening. Equally important is that all material goods such as foodstuffs and parts and supplies are sterilized remotely before delivery to the zone. Our strict ship access procedures ensure that the cruises remain contamination free.

#### **Ground Transfers**

Embarkation and disembarkation transfers are effected by our own staff in vehicles that are sterilized with electrostatic fogging devices. We choreograph the arrival of people and goods to eliminate waiting and to ensure efficient boarding. Though optional, we strongly encourage that airport transfers be conducted by our trained staff in commercial sterilized vehicles. This way we can be sure that the most complete health precautions have been taken.

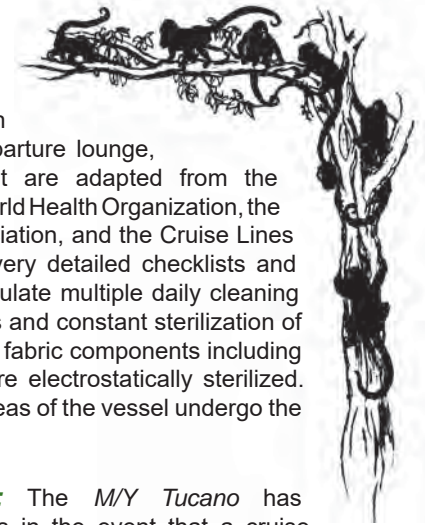

#### **Housekeeping**

Protocols for the sterilization of our vessel, arrival / departure lounge, and all of the equipment are adapted from the recommendations of the World Health Organization, the Latin America Travel Association, and the Cruise Lines Industry of America. Our very detailed checklists and verification procedures stipulate multiple daily cleaning of accommodations spaces and constant sterilization of high touch surfaces. All the fabric components including mattresses and curtains are electrostatically sterilized. Crew quarters and utility areas of the vessel undergo the same cleaning procedures.

**Emergency Planning:** The *M/Y Tucano* has emergency response plans in the event that a cruise participant were to become ill. Pre-established relationships with medical facilities and personnel ensure that timely and appropriate medical assistance is available when needed. Evacuation contingencies are elaborated and contacts kept current. In the event that self-quarantine were to be necessary, vessel cabin space is identified and procedures for caring for ill travelers while preserving vessel health are outlined. Should self-quarantine be necessary in the city of Manaus, we have full apartments available along with plans for providing a safe meal service, continuous assistance, and health monitoring.

**Traveler Advocacy:** At all times Amazon Nature Tours is prepared to assist travelers and advocate for their health and well being while they are in the Amazon. This extends to verifying with hotel operators that health and safety best practices are followed.

**Staffing and Training:** The most important of measures in implementing our safe zone is our staff. All of the marine and land-based crew members are diligent, highly trained, and have a commitment to assisting travelers. Many of our mariners have worked with us for more than 20 years. An ongoing training effort reminds us all of the fine details necessary to maintain our safe zone

**Private Voyages:** These full boat cruises enable friends and family members join in an Amazon cruise exclusively for their group. This is a thrilling way to experience the Amazon and for some travelers adds additional confidence in travelling. The trip can still further be enhanced when services in the city such as airport transfers and city tours are conducted by our company. This ensures that travelers are always accompanied by guides and staff that take maximum care to provide a healthy experience.